

STOOL DRAINAGES — hyghtec® basic-plus

... for reliably closed continuous drainage of liquid stool

efficient sealing, even for watery thin diarrhea

designed for consequent bowel management

tissue friendly, low-pressure filling with air

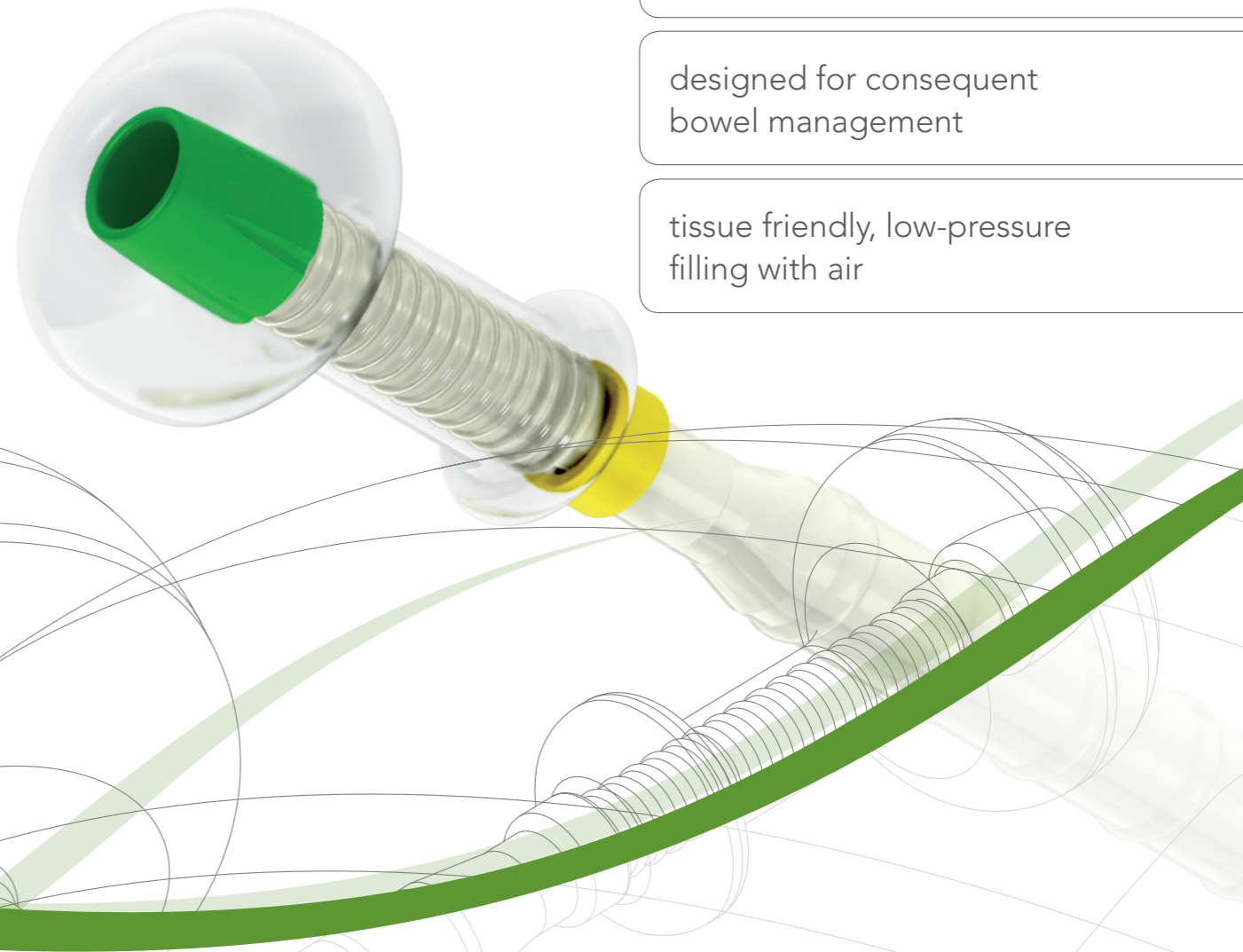

Product	Article Number	Contents/ Carton
hyghtec basic-plus	V01-10017	1 drainage
hyghtec bag	V01-10016-05	5 stool collection bags
	V01-10016-10	10 stool collection bags
	V01-10016-50	50 stool collection bags (5x10)

The blister package contains a stool drainage, a stool collection bag (hyghtec bag), an inflation syringe with volume indicator and a detailed manual.

presented by:

Distribution:

Advanced Medical Ballons GmbH | Bruchsaler Straße 22 | 68753 Waghäusel | Germany
info@hyghtec.com | www.hyghtec.com

Manufacturer:

Creative Balloons GmbH | Bruchsaler Straße 22 | 68753 Waghäusel | Germany



hyghtec® basic-plus – Design

... intelligent, sphincter-synchronized, trans-anal sealing

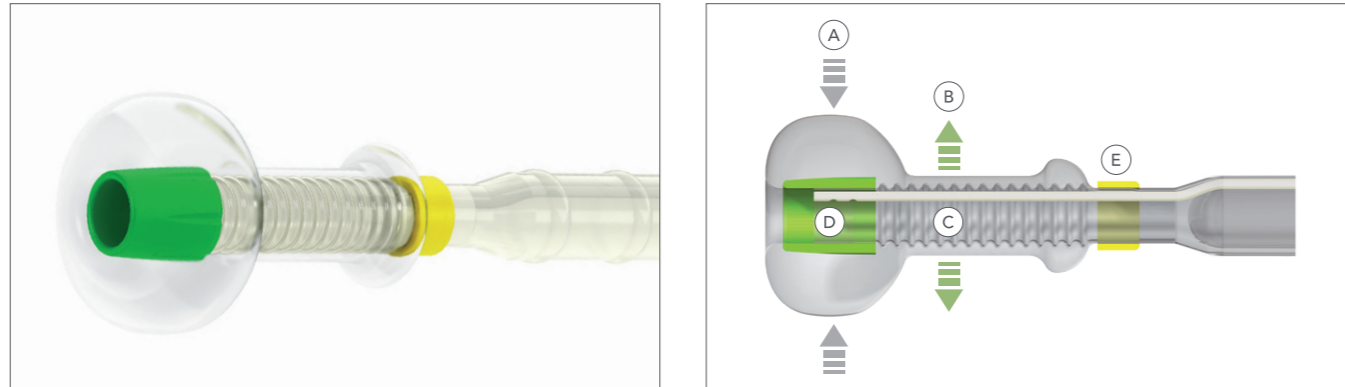

A – intra-rectal anchoring balloon segment | **B** – trans-anal sealing balloon segment | **C** – stool-draining tube element | **D** – olive-shaped tip for easy insertion | **E** – ring marking for checking of trans-anal positioning

System Rinsing and Rectal Irrigation

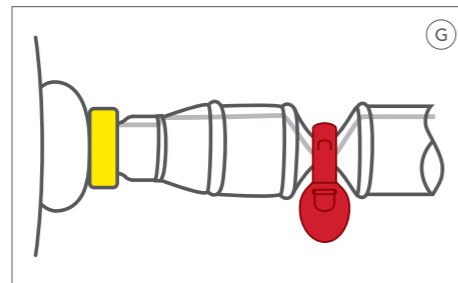
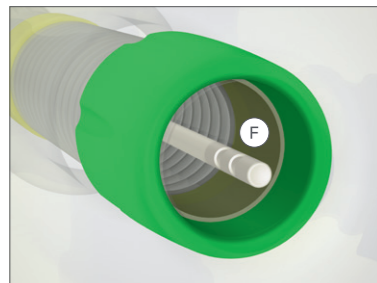

F – atraumatic irrigation into the drainage opening | **G** – closure strap for rectal irrigation

Stool Modification*

hyghtec basic-plus allows for continuous liquification of stool, granting consequent bowel management and so far unachieved patient hygiene.

- **Polyethylene glycol (e.g. Macrogol® bag 1-0-1)** The Macrogol powder stays on the medication chart until the system is removed.
- **Sodium picosulfate (e.g. Laxoberal® drops 12-0-0)** Laxoberal is the first substance to be discontinued (generally after 3 – 5 days), as soon as thin, liquid stools are obtained through irrigation. If the effect is intense/in the event of abdominal discomfort, reduce the dose to 8 drops.
- **Sab-Simplex® (10-0-10 ml)** The administration of Sab-Simplex reduces abdominal discomfort and allows the gas to „be released“ more easily.

In addition to oral medication, carry out rectal irrigation once a day with 250 to 500 ml of crystalloid irrigation solution at body temperature.

*All stool modification methods must be prescribed by the treating physician.

Advantages

... an innovative, functionally superior design made of polyurethane

separation of stool-draining and stool-sealing functions

optimized seal performance thanks to micro-thin-walled balloon components

combined rectal and trans-anal balloon seal

dynamically adapts to the motility of the rectum and sphincter

consistent sealing for watery thin stool

only partly inflated with air, offering low-pressure performance

efficient odor barrier performance

hyghtec drainages incorporate a trans-anally sealing and anchoring balloon element made of micro-thin-walled, extremely durable polyurethane. The balloon is fully pre-formed during manufacturing. Once in place, it is only partly filled, optimally adapting to the patient's individual anatomy at the lowest possible filling pressure.

hyghtec basic absorbs the pressures at work in the patient's body in the intra-rectal segment **(A)** using them for sealing in the trans-anal segment **(B)**. As such, the trans-anal sealing effect automatically adjusts to changing levels of intra-rectal pressure.

Other than conventional drainages made from silicone, hyghtec drainages are filled with air. The air volume is defined by a provided filling syringe.

The extracorporeal part of hyghtec basic-plus is made from efficiently odor sealing PVC material.

hyghtec stool drainages represent a fundamental contribution to infection-preventive contamination containment of the care environment (COCO).